

- **Reliable, low maintenance rotating disc drip trap**
- **Heavy duty electric actuator**
- **NEMA 7 Explosion-proof actuator housing**
- **3 or 6 quart bowl**
- **5 or 60 PSI pressure rating**

DRIP TRAP

The Model 8490 electrically operated drip trap combines the reliability of a rotating disc manual drip trap with the convenience of an automatic drip trap.

It can be controlled by an integral cycle timer, a Groth remote sequence controller, or the owner's master control system.

The drip trap is a standard Groth Model 8470, equipped with an electric valve actuator in a NEMA 7 housing, so it can operate automatically with the optimum fill/drain cycle to suit your condensate removal requirements. It is available with either 3 or 6 quart bowl capacity and rated for up to 60 PSIG condensate line pressure. The drip trap utilizes O-rings in contact with a polished stainless steel disc, so gas cannot escape in any position.

An integral cycle timer can be provided in the actuator housing. Both fill and drain times can be independently adjusted from 30 seconds to 12 hours.

A separate local or remote control panel can be provided for cycle timing single or multiple drip traps. Time intervals can be independently adjusted from 30 seconds to 30 hours. The panels have manual or automatic control with dry contacts for both local and remote position status and fault indication, in a NEMA 7 enclosure.

Consult factory for additional materials of construction, soft goods, controls systems, NEMA classifications or other requirements.



MODEL 8490

STANDARD FEATURES

- Reliable, low maintenance rotating disc drip trap
- Heavy duty electric actuator
- Visual position indicator
- Electronic contacts for remote position indication
- Explosion-proof actuator housing
- Override for manual operation
- Low copper aluminum construction
- 3 or 6 quart bowl
- 5 or 60 PSI pressure rating

OPTIONS

- Integral cycle timer
- Remote control panel
- Insulating jacket
- Actuator heater

SPECIFICATIONS

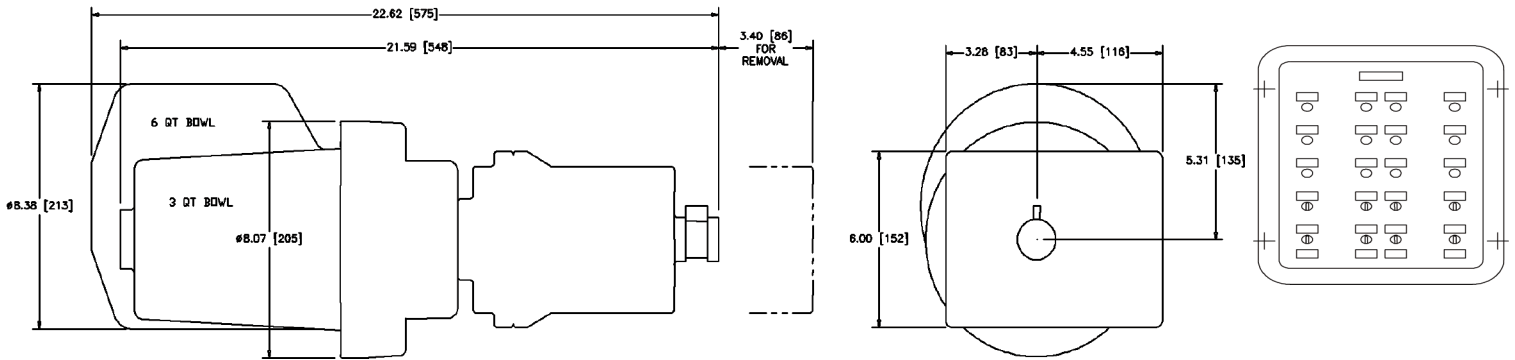

Drip trap:

Drip trap housing & bowl	Low copper aluminum
Drip trap seal disc	316SS
Drip trap shaft	304SS
Drip trap o-rings	Buna-N

Actuator:

Open/Close speed	10 Sec.
Enclosure class	NEMA 7
Status limit switches	Two SPDT
Visual indicator	Mechanical
Manual over-ride	With standard wrench
Temp rating	-40 to 150 of
Voltage	115 VAC
Motor	High torque, reversible, overload protected
Gearing & shaft	Hardened alloy steel
Lubrication	Permanent
Bracket	Heavy gage aluminum
Coupling	304 SS
Cycle timer [integral]	30 seconds to 12 hours ON/OFF independent

Remote control panel:

Manual/Automatic selector switch	Open/Closed selector switch in manual mode
Cycle timer for automatic mode	30 seconds to 30 hours ON/OFF independent
Indicating lights to show Fill/Drain status	Dry contacts for remote Fill/Drain status
Fault alarm for failure to Open/Close	Dry contacts for remote fault status
NEMA 7 enclosure	Panel controls multiple drip traps

HOW TO ORDER

For easy ordering, select proper model numbers

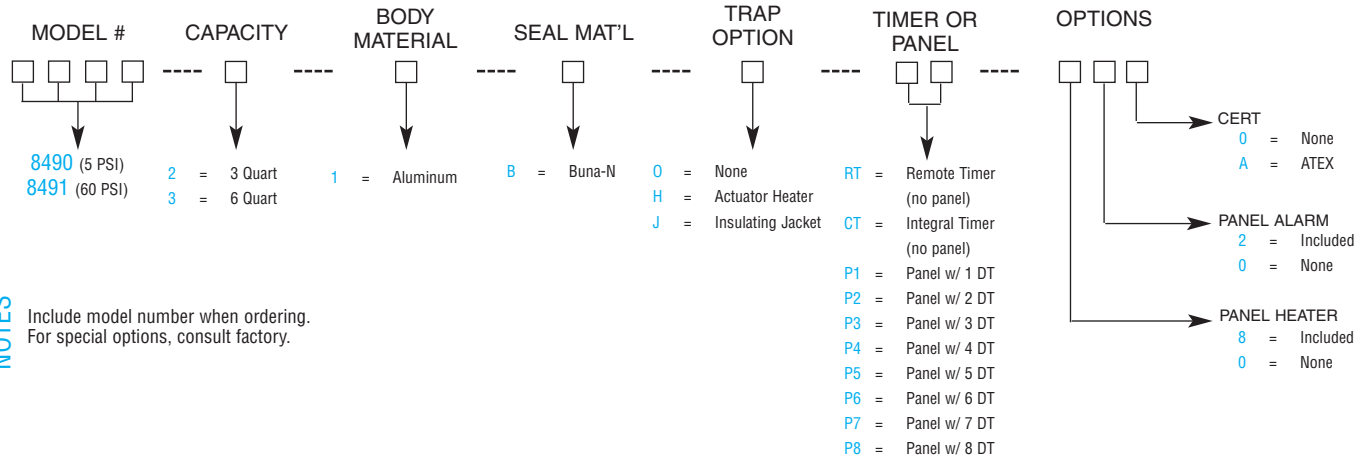

NOTES
Include model number when ordering.
For special options, consult factory.

EXAMPLE

8 4 9 0 - 2 - 1 - B - 0 - C T - 0 0 0

Indicates a 3 quart Electrically Actuated Drip Trap with Aluminum body, Buna-N seal and Integral Cycle Timer.

Groth Corporation has representatives throughout the world.
Contact the Groth Corporation office nearest you for the authorized representative in your area.



GROTH CORPORATION

13650 N. Promenade Blvd.
Stafford, Texas 77477 USA
Phone: 281-295-6800
FAX: 281-295-6999
Toll-Free: 800-354-7684
E-mail: sales@grothcorp.com
Website: www.grothcorp.com